

M36 (TLED04-R65)

LED LIGHTHEAD

E6 XA1
000040

E6 XB1
000083



FEATURES

- High-Intensity 1W LED x 4pcs
- Multi-Voltage Input 12~24VDC
- Built-in 23 Selectable Flash Patterns
- LEDs rated to 100,000 hours of operation.
- Non-volatile memory recalls last flash pattern used at power up.
- Multiple units are synchronizable and can flash simultaneously or alternately.
- Reverse polarity protection.
- Weatherproof and vibration resistant design for external or internal use.
- Aluminum base for heat dissipation.

SPECIFICATIONS

Meets: ECE R65 (XA1, XB1)

Bulb: 1W LED x 4pcs

Warning Patterns: 23 Flash Patterns

Operating Voltage: 12~24VDC

Avg. Current: 0.32A @12.8VDC 0.17A @24VDC
(varies with flash pattern)

Avg. Power: 4.1 Watts (varies with flash pattern)

Max. Current: 0.64A@12.8VDC 0.34A@24VDC

Max. Power: 8.2 Watts

Wires: Red-Vcc: 20cm (20AWG)

Black-GND: 20cm (20AWG)

Yellow-Flash Patterns & Sync: 20cm (20AWG)

White-Phase: 20cm (20AWG)

Fuse Recommend: 3A

Multi-Unit Synchronization: Over 15

Storage Temperature: -40°C to +75°C

Operating Temperature: -30°C to +65°C

Available in: AMBER, BLUE

DIMENSIONS

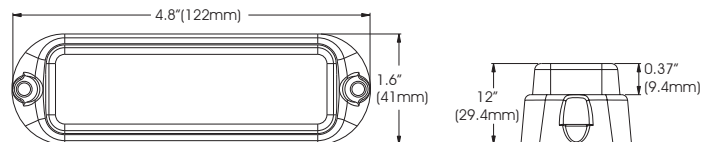

PART NO.

- M36-2B03A-00 (AMBER, R65)
- M36-2B03B-00 (BLUE, R65)

FLASH PATTERN

| FP# | Flash Patterns | | |
|-----|---------------------|----|--------------------|
| 1 | Single (2Hz) | 13 | Single H/L (split) |
| 2 | Double (R65) | 14 | Single (all) (SAE) |
| 3 | Triple (2Hz) | 15 | Double (all) (SAE) |
| 4 | Quad (2Hz) | 16 | Quad (all) (SAE) |
| 5 | Random | 17 | Quint (all) (SAE) |
| 6 | Single (split) | 18 | Mega (all) |
| 7 | Double (split) | 19 | Ultra (all) (SAE) |
| 8 | Quad (split) | 20 | Single-Quad (all) |
| 9 | Quint (split) | 21 | Single H/L (all) |
| 10 | Mega (split) | 22 | Steady 2 (half) |
| 11 | Ultra (split) | 23 | Steady 4 (all) |
| 12 | Single-Quad (split) | | |

*SPLIT=side by side alternating *ALL=all LEDs on